

DXA4044U INSTRUCTIONS

OEX

PRODUCT OVERVIEW

Toyota LandCruiser 79, 80 & 100 Series are fitted with one of two different regulators in the alternator:

Power to "L" terminal, utilising an active warning light circuit to drive a glow plug relay / control relay.

No power to "L" terminal, with an inactive warning light circuit not to drive a glow plug relay / control relay.

Upon visual inspection, both OE alternators appear identical. As a result, many repairers order the incorrect model and inadvertently cause a fault in the system. To overcome this challenge, OEX developed the DXA433U & DXA4044U alternators.

CIRCUIT SWITCHING FUNCTION

The DXA4044U is supplied with the active warning light function as default.

To change it to an inactive warning light function:

1. Remove the red rubber bung.
2. Remove the screw.
3. Replace rubber bung to cover the opening.

Note: Engine must be turned off during this process.

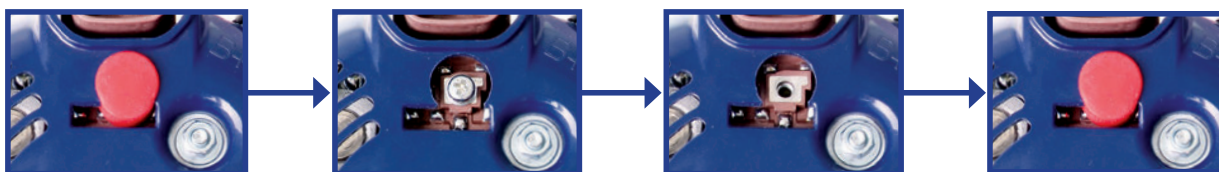

WIRING DIAGRAM

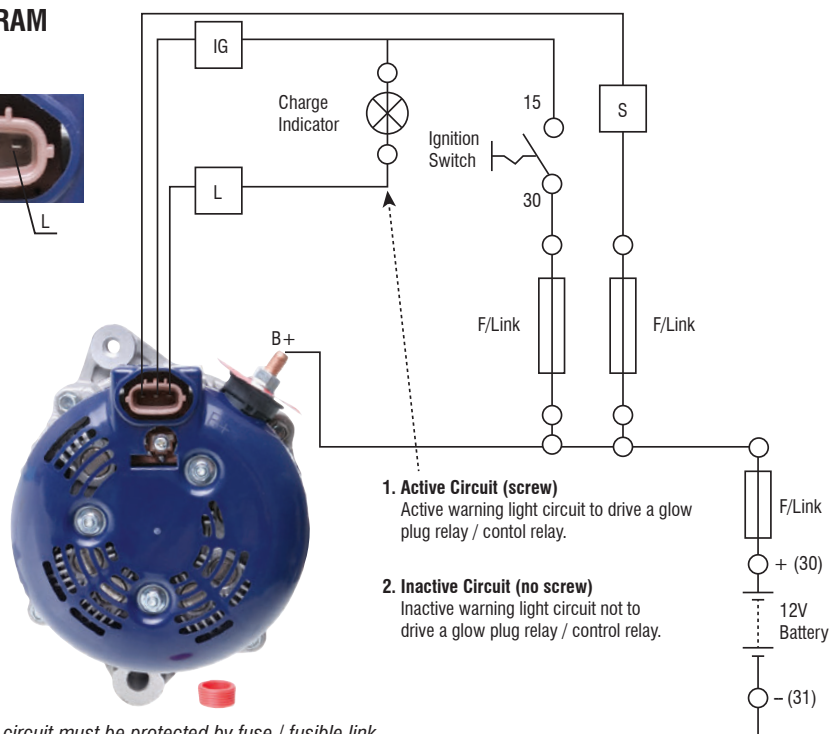
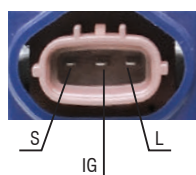

ATTENTION:

Alternator to battery circuit must be protected by fuse / fusible link.
Please check fuse / fusible link for suitability.

OEX

www.oex.com.au | www.oex.co.nz

Patented Innovation. Copyright © 2016 Ashdown-Ingram ABN 97 097 993 283